

## 67364 1-1/4 - 11-1/2 N.P.T. COOL AIR KIT

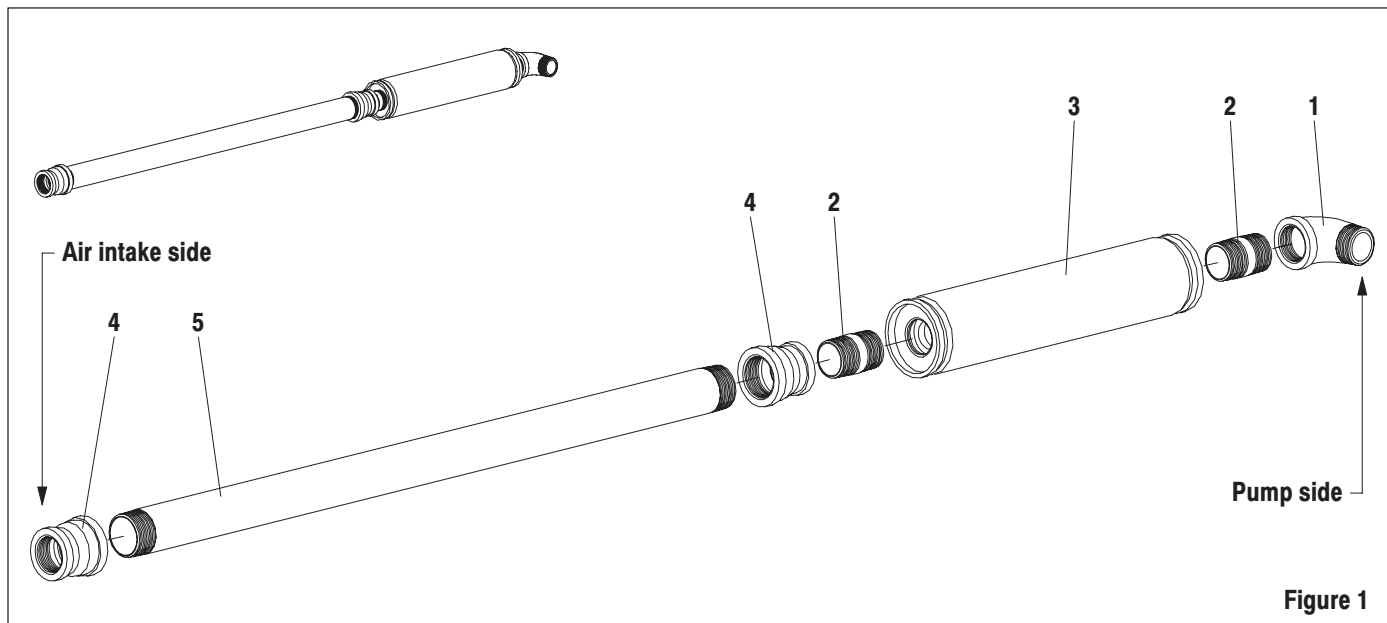

Figure 1

### PARTS LIST

Item	Description (size)	Qty	Part No.	Item	Description (size)	Qty	Part No.
1	90° Street Elbow (1-1/4 - 11-1/2 N.P.T.)	(1)	Y43-7-C	4	Reducing (1-1/2 - 11-1/2 N.P.T. female x 1-1/4 - 11-1/2 N.P.T. female)	(2)	Y202-9
2	Nipple, Short (1-1/4 - 11-1/2 N.P.T. x 2-1/2")	(2)	Y27-57-C	5	Pipe (1-1/2 - 11-1/2 N.P.T. x 36")	(1)	15237852
3	Silencer (1-1/4 - 11-1/2 N.P.T., female)	(1)	32323560				

### OPERATING AND SAFETY PRECAUTIONS

<b>⚠ WARNING</b>	= Hazards or unsafe practices which could result in severe personal injury, death or substantial property damage.
<b>⚠ CAUTION</b>	= Hazards or unsafe practices which could result in minor personal injury, product or property damage.
<b>NOTICE</b>	= Important installation, operation or maintenance information.

- ⚠ WARNING** EXCESSIVE INLET AIR PRESSURE. Do not exceed the maximum material pressure of any component in the system.
- ⚠ WARNING** HAZARDOUS PRESSURE. Can result in serious injury or property damage. Do not service or clean pump, hoses or dispensing valve while the system is pressurized.
- ⚠ CAUTION** Be certain all operators of this equipment have been trained for safe working practices, understand it's limitations, and wear safety goggles / equipment when required.

### INSTALLATION

1. Disconnect all power supplies to the pump.
2. Remove the air inlet filter and set aside.
3. Connect the piping to the motor inlet (as shown). In most cases, a pipe sealant should be used on thread connections. Tighten all fittings.
4. Reattach the air inlet filter. NOTICE: Failure to reattach the air inlet filter will void any warranty.
5. Reconnect all power supplies to the pump.

### SERVICE

- USE ONLY GENUINE IR® REPLACEMENT PARTS TO ASSURE PERFORMANCE AND PRESSURE RATING.
- Repairs should be made only by authorized trained personnel. Contact your local authorized IR Service Center for parts and customer service information.

PN 97999-1148

INGERSOLL-RAND COMPANY  
P.O. BOX 151 • ONE ARO CENTER • BRYAN, OHIO 43506-0151  
☎ (800) 276-4658 • FAX (800) 266-7016 ©2004 CCN 15237811

